

## **Heritage Horse Show – December 12-13, 2020**

Thank you for supporting our show on December 12-13, 2020 at Jim Brandon Equestrian Center. We are looking forward to seeing everyone and putting on a great horse show. Some aspects of the show will be different than what we are accustomed to so we have put together some information to help everyone know what to expect.

### **Rules regarding COVID-19:**

- Anyone that does not feel well or has been exposed to the virus should stay home.
- Face masks are required for everyone. A person schooling and competing on their horse is not required to wear a mask. Face masks are also not required while consuming foods or beverages.
- Maintain social distancing whenever possible.
- Do not congregate in large groups.
- Spectators are not allowed. We allow two parents per rider.
- Only essential people in the barn area, schooling rings, and show rings.
- Please respect the show staff and keep six feet distance.
- Riders and trainers for the current division or the next division should be at the show ring or in the schooling ring.

### **Schooling:**

Schooling is from 11:00 am to 6:00 pm on Friday. Schooling is also available in the morning from sunrise to 7:30 am on show mornings except in the young hunter ring it will be open until 8 am. Start time is 8 am in jumper and main hunter ring. Young hunter ring start time is 8:30 am.

### **Registration:**

We have included the class list and entry form. All of these forms can also be found on our website. The entry form can be filled out electronically or by hand. We appreciate any forms that are sent by Thursday. Email to [heritagehorsesho@aol.com](mailto:heritagehorsesho@aol.com) and send all questions to Lauren at (954)448-5492. If you can't send early, please enter by 2 pm on Friday. Adds, scratches, and any changes should be texted to Lauren. Even if you add or scratch at the gate please text to Lauren. Riders or their parent/legal guardian will need to sign two additional waivers including the Palm Beach County Waiver and the COVID-19 Waiver. Membership forms are also due if you haven't competed in October or November.

### **Team Challenge Competition:**

2020 will not stop us from having our annual team challenge competition. The entry form is included in the packet. It is \$15 per team or \$5 per rider. A team consists of three riders. They will choose three of their classes either from Saturday, Sunday or both. A rider may be on as many teams as they like (i.e. a team of three riders may have a team using Saturday classes and then create another with the same riders but using Sunday classes). We encourage the kids to mingle with other barns and create teams with their friends.

See attached site map and driving directions included. The address for the facility will take you to a service entrance when put into a GPS or navigation. **Stall assignments will be posted and/or texted.**

# Jumper Ring

**Saturday** 8:00 am

89. Training Jumper (2b) 3'

90. Training Jumper (2.1)

**400. \$1000 Training Jumper Classic (2b)**

92. Low Schooling Jumper (2b) 3'3"-3'6"

93. Low Schooling Jumper (2.1)

**401. \$1000 Low Schooling Jumper Classic (2b)**

95. High Schooling Jumper (2b) 3'9"-4'

96. High Schooling Jumper (2.1)

**97. High Schooling Jumper Addback (2b)**

98. Tadpole Jumper (2b) Cross rail

99. Tadpole Jumper (2.1)

100. Tadpole Jumper (2b)

101. Froggy Jumper (2b) 18"

102. Froggy Jumper (2.1)

**103. Froggy Jumper Addback (2b)**

104. Novice Jumper (2b) 2'

105. Novice Jumper (2.1)

**106. Novice Jumper Addback (2b)**

107. Schooling Jumper (2b) (Green Horses only) 2'3"

108. Schooling Jumper (2.1)

109. Schooling Jumper (2b)

110. Beginning Jumper (2b) 2'3"

111. Beginning Jumper (2.1)

**402. \$500 SW Ranches Equine Insurance Beginning Classic (2b)**

113. Hopeful Jumper (2b) 2'6"-2'9"

114. Hopeful Jumper (2.1)

**403. \$500 Hopeful Jumper Classic (2b)**

**Sunday** 8:00 am

289. Training Jumper (2b) 3'

290. Training Jumper (2.1)

**291. Training Jumper Addback (2b)**

292. Low Schooling Jumper (2b) 3'3"-3'6"

293. Low Schooling Jumper (2.1)

**294. Low Schooling Jumper Addback (2b)**

295. High Schooling Jumper (2b) 3'9"-4'

296. High Schooling Jumper (2.1)

**297. High Schooling Jumper Addback (2b)**

298. Tadpole Jumper (2b) Cross rail

299. Tadpole Jumper (2.1)

**300. Tadpole Jumper (2b)**

301. Froggy Jumper (2b) 18"

302. Froggy Jumper (2.1)

**303. Froggy Jumper Addback (2b)**

304. Novice Jumper (2b) 2'

305. Novice Jumper (2.1)

**306. Novice Jumper Addback (2b)**

307. Schooling Jumper (2b) (Green Horses only) 2'3"

308. Schooling Jumper (2.1)

309. Schooling Jumper (2b)

310. Beginning Jumper (2b) 2'3"

311. Beginning Jumper (2.1)

**312. Beginning Jumper Addback (2b)**

313. Hopeful Jumper (2b) 2'6"-2'9"

314. Hopeful Jumper (2.1)

**315. Hopeful Jumper Addback (2b)**

**Class 402 \$500 Beginning Classic**

**Class 403 \$500 Hopeful Classic**

PRE ENTRY: \$40 POST ENTRY: \$50

PRIZE MONEY: \$150, \$110, \$60, \$50, \$45, \$45, \$40

9-10 Entries: \$150, \$110, \$60, \$50, \$45, \$45

8 Entries: \$150, \$100, \$60, \$50

6-7 Entries: \$120, \$100, \$60

5 Entries: \$110, \$90, \$40

**Class 400 \$1000 Training Classic**

**Class 401 \$1000 Low Schooling Classic**

PRE ENTRY: \$80 POST ENTRY: \$90

PRIZE MONEY: \$300, \$195, \$130, \$110, \$95, \$90, \$80

9-10 Entries: \$230, \$155, \$125, \$100, \$90, \$80

8 Entries: \$230, \$150, \$120, \$100, \$80

6-7 Entries: \$230, \$150, \$120, \$40

5 Entries: \$200, \$150, \$80

Classes may not be held if less than 5 entries. Horse/Rider combination must show at least one class in the division.

## Young Hunter Ring - (8:00) (Saturday)

500. Halter Confirmation  
501. Hunter In-Hand

1. Leadline Walk (7 & under)  
2. Leadline Walk/Trot  
3. Leadline Walk Command

4. Walk Equitation (10 & under)  
5. Walk/Trot Equitation  
6. Walk/Trot Hunter  
7. Walk/Trot Equitation Jump (1 'X')

8. Open Walk Equitation  
9. Open Walk/Trot Equitation  
10. Open Walk/Trot Hunter  
11. Open Walk/Trot Equitation Jump (1 'X')

12. Walk/Trot Hunter (13 & under)  
13. W/T/C Equitation  
14. Beginning Crossrail Hunter O/F  
15. Beginning Crossrail Equitation O/F  
16. Beginning Crossrail Medal O/F

17. Junior/ Adult Walk/Trot Hunter  
18. Junior/Adult W/T/C Equitation  
19. Junior/Adult Beginning Crossrail Hunter O/F  
20. Junior/Adult Beginning Crossrail Equitation O/F  
21. Junior/Adult Beginning Crossrail Medal O/F

22. Crossrail Hunter U/S (15 & under)  
23. Crossrail Equitation Flat  
24. Crossrail Hunter O/F  
25. Crossrail Equitation O/F  
26. Crossrail Equitation Medal O/F

27. Open Beginning Hunter U/S  
28. Open Beginning Equitation Flat  
29. Open Beginning Hunter O/F  
30. Open Beginning Equitation O/F  
31. Open Beginning Equitation Medal O/F  
\*\* Shown at crossrail or 18"

32. Green Horse/Pony Hunter U/S  
33. Warm Up O/F  
34. Green Horse/Pony Hunter O/F  
35. Green Horse/Pony Hunter O/F  
\*\* Shown at crossrail or 18"

36. Short Stirrup Hunter U/S (16 & under)  
37. Short Stirrup Equitation Flat  
38. 18" Warm Up  
39. Short Stirrup Hunter O/F 18"  
40. Short Stirrup Equitation O/F  
41. Short Stirrup Equitation Medal O/F

42. Novice Hunter U/S  
43. Novice Equitation Flat  
44. 2' Warm Up  
45. Novice Hunter O/F 2'  
46. Novice Equitation O/F  
47. Novice Equitation Medal O/F

## **Don't forget to sign up for the Team Challenge**

### Main Hunter Ring (8:00) (Saturday)

**230. 2'3" Warm up\***  
**260. 2'6" Warm Up\***  
**290. 2'9" Warm Up\***  
**300. 3' Warm Up\***

**\*Horse/Rider combination may do one warm up class  
at each height. Warm up classes will be ridden  
during their division and will not count for points.**

57. Pleasure  
58. Hunter U/S  
59. Hunter Hack 2'

54. Schooling Hunter Section A O/F 2'3"  
55. Schooling Hunter Section A O/F  
56. Schooling Hunter Section A U/S

60. Low Hunter U/S  
61. Modified Equitation Flat  
62. Low Hunter O/F 2'3"  
63. Low Hunter O/F  
64. Modified Equitation O/F 2'3"  
65. Modified Equitation Medal O/F

49. Pony Pleasure U/S  
50. Pony Hunter U/S  
51. Pony Hunter O/F  
52. Pony Hunter O/F  
53. Child Pony Medal  
\*\*Shown in 2 sections: 2' & 2'6"

66. Child/Adult Hunter U/S  
67. Child/Adult Equitation Flat  
68. Child/Adult Hunter O/F 2'6"  
69. Child/Adult Hunter O/F  
70. Child/Adult Equitation O/F  
71. Child/Adult Equitation Medal O/F

72. Schooling Hunter Section B U/S  
73. Schooling Hunter Section B O/F  
74. Schooling Hunter Section B O/F  
\*\*Shown in 3 sections: 2'6", 2'9" & 3'

75. Junior/Adult Hunter U/S  
76. Junior/Adult Equitation Flat  
77. Junior/Adult Hunter O/F  
78. Junior/Adult Hunter O/F  
79. Junior/Adult Equitation O/F  
80. Junior/Adult Equitation Medal O/F  
\*\*Shown in 2 sections: 2'9" & 3'

## Young Hunter Ring - (8:30) (Sunday)

600. Halter Confirmation  
601. Hunter In-Hand

201. Leadline Walk (7 & under)  
202. Leadline Walk/Trot  
203. Leadline Walk Command

204. Walk Equitation (10 & under)  
205. Walk/Trot Equitation  
206. Walk/Trot Hunter  
207. Walk/Trot Equitation Jump (1 'X')

208. Open Walk Equitation  
209. Open Walk/Trot Equitation  
210. Open Walk/Trot Hunter  
211. Open Walk/Trot Equitation Jump (1 'X')

212. Walk/Trot Hunter (13 & under)  
213. W/T/C Equitation  
214. Beginning Crossrail Hunter O/F  
215. Beginning Crossrail Equitation O/F  
216. Beginning Crossrail Medal O/F

217. Junior/Adult Walk/Trot Hunter (14 & over)  
218. Junior/Adult W/T/C Equitation  
219. Junior/Adult Beginning Crossrail Hunter O/F  
220. Junior/Adult Beginning Crossrail Equitation O/F  
221. Junior/Adult Beginning Crossrail Medal O/F

222. Crossrail Hunter U/S (15 & under)  
223. Crossrail Equitation Flat  
224. Crossrail Hunter O/F  
225. Crossrail Equitation O/F  
226. Crossrail Equitation Medal O/F

227. Open Beginning Hunter U/S  
228. Open Beginning Equitation Flat  
229. Open Beginning Hunter O/F  
230. Open Beginning Equitation O/F  
231. Open Beginning Equitation Medal O/F  
\*\* May be shown at crossrail or 18"

232. Green Horse/Pony Hunter U/S  
233. Warm Up O/F  
234. Green Horse/Pony Hunter O/F  
235. Green Horse/Pony Hunter O/F  
\*\* May be shown at crossrail or 18"

236. Short Stirrup Hunter U/S (16 & under)  
237. Short Stirrup Equitation Flat  
238. 18" Warm Up  
239. Short Stirrup Hunter O/F 18"  
240. Short Stirrup Equitation O/F  
241. Short Stirrup Equitation Medal O/F

242. Novice Hunter U/S  
243. Novice Equitation Flat  
244. 2' Warm Up  
245. Novice Hunter O/F 2'  
246. Novice Equitation O/F  
247. Novice Equitation Medal O/F

## Main Hunter Ring - 8:00 (Sunday)

**230. 2'3" Warm Up\***  
**260. 2'6" Warm Up\***  
**290. 2'9" Warm Up\***  
**300. 3' Warm Up\***

**\*Horse/Rider combination may do one warm up  
class at each height. Warm up classes will be  
ridden during their division and will not count  
for points.**

57. Pleasure  
58. Hunter U/S  
59. Hunter Hack 2'

254. Schooling Hunter Section A O/F 2'3"  
255. Schooling Hunter Section A O/F  
256. Schooling Hunter Section A U/S

260. Low Hunter U/S  
261. Modified Equitation Flat  
262. Low Hunter O/F 2'3"  
263. Low Hunter O/F  
264. Modified Equitation O/F 2'3"  
265. Modified Equitation Medal O/F

249. Pony Pleasure U/S  
250. Pony Hunter U/S  
251. Pony Hunter O/F  
252. Pony Hunter O/F  
253. Child Pony Medal  
\*\*Shown in 2 sections: 2' & 2'6"

266. Child/Adult Hunter U/S  
267. Child/Adult Equitation Flat  
268. Child/Adult Hunter O/F 2'6"  
269. Child/Adult Hunter O/F  
270. Child/Adult Equitation O/F  
271. Child/Adult Equitation Medal O/F

272. Schooling Hunter Section B U/S  
273. Schooling Hunter Section B O/F  
274. Schooling Hunter Section B O/F  
\*\*Shown in 3 sections: 2'6", 2'9" & 3'

275. Junior/Adult Hunter U/S  
276. Junior/Adult Equitation Flat  
277. Junior/Adult Hunter O/F  
278. Junior/Adult Hunter O/F  
279. Junior/Adult Equitation O/F  
280. Junior/Adult Equitation Medal O/F  
\*\*Shown in 2 sections: 2'9" & 3'

Class 232 (U/S)  
is held after  
class 28

# Entry Form

Barn/Trainer: \_\_\_\_\_

Back #: \_\_\_\_\_

Rider Name: \_\_\_\_\_

Horse Name: \_\_\_\_\_

Address: \_\_\_\_\_

\_\_\_\_\_ Phone: \_\_\_\_\_

Trainer: \_\_\_\_\_ Phone: \_\_\_\_\_

Signature: \_\_\_\_\_

(Please read waiver below. Must be 18 or older to sign)

BY SIGNING THIS AGREEMENT I/WE ACKNOWLEDGE AND AGREE TO ASSUME ALL RESPONSIBILITIES AND RISKS ASSOCIATED WITH MY OR MY CHILD'S PARTICIPATION IN HERITAGE HORSE SHOWS AND FURTHER AGREE TO HOLD HARMLESS COMPETITION MANAGEMENT, ITS EMPLOYEES, DIRECTORS, AGENTS, MEMBERS, AND THE CITY OF PLANTATION FROM ANY CLAIM WHATSOEVER FOR EXPENSE, LOSS, INJURY TO PERSON OR PROPERTY, OR SEATH OF ANY PERSON OR HORSE THAT MAY ARISE OUT OF OR IN CONNECTION WITH HERITAGE HORSE SHOW. I AM FURTHER WARNED THAT UNDER FLORIDA LAW, ANY EQUINE SPONSOR OR EQUINE PROFESSIONAL IS NOT LIABLE FOR ANY INJURIES TO, OR DEATH OF, A PARTICIPANT IN ANY EQUINE ACTIVITIES EFFECTIVE UNDER FLORIDA LAW. BE WARNED THAT RIDING HORSES/PONIES IN ANY EQUINE SPORT IS AN INHERENTLY DANGEROUS RISK TO THE RIDER AND/OR PROPERTY (SENATE BILL 1658-SECTION 91.1A). ALL JUNIOR RIDERS MUST WEAR REGULATION HELMETS AND CHIIN STRAPS MUST BE SECURELY FASTENED WHILE MOUNTED. ALL RIDERS MUST WEAR A HELMET WHILE JUMPING.

## PAYMENT SCHEDULE

Hunter/Equitation Class Entry Fee @ \$20.00	X _____	_____
Jumper Ring Class Entry Fee @ \$23.00	X _____	_____
Hunter/Equitation Prepaid Entry Fee @ \$18.00	X _____	_____
Jumper Ring Class Prepaid Entry Fee @ \$21.00	X _____	_____
Addbacks @ \$35.00	X _____	_____
Classic #402, 403, 600, 700 @ \$50.00	X _____	_____
Classic #400, 401, 800, 900 @ \$90.00	X _____	_____
Non-Showing Fee @\$25.00		_____
Administration Fee		\$15.00
Schooling Fee		\$15.00
Membership @\$30.00 (Family \$50.00)		_____
Non-member Fee @\$10.00		_____
Stall Fee @ \$85.00	X _____	_____
Haul In Fee (No Stall) @ \$20.00	X _____	_____
Tack Stall Share Fee (\$100.00)	X _____	_____
Stall Watch @ \$5.00 per night	X _____	_____
Shavings @ \$9.00/bag	X _____	_____
Credit card processing fee @ 3%	X _____	_____

**December 12-13, 2020**

**Jim Brandon  
Equestrian Center**

Please page 2 and 3.

Palm Beach County and  
COVID-19 Liability  
Waiver must be signed.

## **Saturday Classes**

\_\_\_\_\_

\_\_\_\_\_

## **Sunday Classes**

\_\_\_\_\_

\_\_\_\_\_

- We accept cash, check and credit cards. Credit card payments will include an additional charge.
- Must leave open check or credit card to obtain back number.
- All prepaid entries close Friday, one week prior to the show. Please mail entries to the address below.
- Unpaid bills will be charged a \$25.00 service fee.

**Make checks payable to:**

**Heritage Equestrian Prod.**

**11351 NW 23<sup>rd</sup> Street Plantation, FL 33323**

Lauren: (954) 448-5492

Butch: (954) 347-1799

Email: [Heritagehorsesho@aol.com](mailto:Heritagehorsesho@aol.com)

[www.HeritageHorseShow.com](http://www.HeritageHorseShow.com)

**Note: USDA requires negative coggins report to be with horse at all times.**



**SUBTOTAL:** \_\_\_\_\_ **Less Winnings:** \_\_\_\_\_

**TOTAL:** \_\_\_\_\_

## **Palm Beach County Waiver. All minors must have parent or legal guardian sign.**

I, the participant, parent or legal guardian of a participant, agree to protect, defend, reimburse, indemnify and hold Palm Beach County, its agents, designees, employees, and elected officials free and harmless at all times from and against all claims, liabilities, losses, costs, fines, damages or causes of action of every kind and character, including attorney's fees and costs, whether at trial or appellate levels or otherwise, arising during, as a result of, or in connection with my participation in this program or from emergency medical care. I hereby assume the risk of participation in this program and agree to hold Palm Beach County, its agents, designees, employees, and elected officials free and harmless at all times from and against all claims, liability, expense, losses, costs, fines, damages, or causes of action of every kind and character, including attorney's fees and costs whether at trial or appellate levels or otherwise, due to their acts, errors, or omissions resulting in bodily injury, including death, or damage to me or my property incident to or in connection with my participation in this program.

Under Florida law, an equine activity sponsor or equine professional is not liable for an injury to, or death of, a participant in equine activities resulting from the inherent risks of equine activities.

\_\_\_\_\_  
**Participant Name (Printed)**

\_\_\_\_\_  
**Date**

\_\_\_\_\_  
**Signature of Participant or Parent/Legal Guardian**

\_\_\_\_\_  
**Name of Parent or Legal Guardian (Printed)**

## **PAYMENT**

It is recommended to do credit card payment for contactless check out. No credit card information is saved after show and all information is destroyed after payment is processed. You can text (preferred) or call (954) 448-5492 to close out.

**Please choose form of payment.**    \_\_\_\_\_ **Credit Card**    \_\_\_\_\_ **Check**    \_\_\_\_\_ **Cash**

If paying with credit card, please complete the following information. Checks and cash may be attached to the entry form.

Card number: \_\_\_\_\_ Expiration date: \_\_\_\_\_ CVV: \_\_\_\_\_

Billing Zip code: \_\_\_\_\_ Signature: \_\_\_\_\_

Phone number or email address to send receipt: \_\_\_\_\_

# COVID-19 Liability Release Waiver

The World Health Organization has declared the novel Coronavirus (COVID-19) a worldwide pandemic. Due to its capacity to transmit from person-to-person through respiratory droplets, the government has set recommendations, guidelines, and some prohibitions which Heritage Equestrian Productions, LLC (the "Organization") adheres to comply.

In consideration of my participation in the foregoing event, the undersigned acknowledge and agree to the following:

- I am aware of the existence of the risk on my physical appearance to the venue and my participation to the activity of the Organization that may cause injury or illness such as, but not limited to Influenza, MRSA, or COVID-19 that may lead to paralysis or death.
- I have not experienced symptoms that of fever, fatigue, difficulty in breathing, or dry cough or exhibiting any other symptoms relating to COVID-19 or any communicable disease within the last 14 days.
- I have not been, nor any member(s) of my household, diagnosed to be infected of COVID-19 virus within the last 30 days.

Following the pronouncements above I hereby declare the following:

- I am fully and personally responsible for my own safety and actions while and during my participation and I recognize that I may be in any case be at risk of contracting COVID-19.
- With full knowledge of the risks involved, I hereby release, waive, discharge the Organization, its board, officers, independent contractors, affiliates, employees, representatives, successors, and assigns from any and all liabilities, claims, demands, actions, and causes of action whatsoever, directly or indirectly arising out of or related to any loss, damage, injury, or death, that may be sustained by me related to COVID-19 while participating in any activity while in, on, or around the premises or while using the facilities that may lead to unintentional exposure or harm due to COVID-19.
- I agree to indemnify, defend, and hold harmless the Organization from and against any and all costs, expenses, damages, lawsuits, and/or liabilities or claims arising whether directly or indirectly from or related to any and all claims made by or against any of the released party due to injury, loss, or death from or related to COVID-19.
- I agree to wear a mask and social distance throughout my participation of the event. Masks are to be worn unless on horseback during competition. Social distance efforts should be made as much as possible including but not limited to barn areas, wash racks, schooling rings, concession stand, show office, in-gate area, show rings, restrooms and haul-in areas.

By signing below I acknowledge that I have read the foregoing Liability Release Waiver and understand its contents; that I am at least eighteen (18) years old and fully competent to give my consent; That I have been sufficiently informed of the risks involved and give my voluntary consent in signing it as my own free act and deed; that I give my voluntary consent in signing this Liability Release Waiver as my own free act and deed with full intention to be bound by the same, and free from any inducement or representation.

---

**Participant Name (Printed)**

---

**Date**

---

**Signature of Participant or Parent/Legal Guardian**

---

**Name of Parent or Legal Guardian (Printed)**



# Heritage Horse Shows

## 2020 - 2021 Membership Application

Rider Name: \_\_\_\_\_

Address: \_\_\_\_\_

City: \_\_\_\_\_ Zip: \_\_\_\_\_

Phone: (\_\_\_\_) \_\_\_\_\_ Birth Date: \_\_\_\_\_

E-mail: \_\_\_\_\_

Horse or Pony Name: \_\_\_\_\_

Trainer: \_\_\_\_\_ Phone: (\_\_\_\_) \_\_\_\_\_

Emergency Contact: \_\_\_\_\_

Mobile #: (\_\_\_\_) \_\_\_\_\_ Phone: (\_\_\_\_) \_\_\_\_\_

Relationship to exhibitor: \_\_\_\_\_

BY SIGNING THIS AGREEMENT I/WE ACKNOWLEDGE AND AGREE TO ASSUME ALL RESPONSIBILITIES AND RISKS ASSOCIATED WITH MY OR MY CHILD'S PARTICIPATION IN HERITAGE HORSE SHOWS AND FURTHER AGREE TO HOLD HARMLESS COMPETITION MANAGEMENT, IT'S EMPLOYEES, DIRECTORS, AGENTS, MEMBERS, AND PLANTATION EQUESTRIAN CENTER FROM ANY CLAIM WHATSOEVER FOR EXPENSE, LOSS, INJURY TO PERSON OR PROPERTY, OR DEATH OF ANY PERSON OR HORSE THAT MAY ARISE OUT OF OR IN CONNECTION TO THE HERITAGE HORSE SHOWS. I AM FURTHER WARNED THAT UNDER FLORIDA LAW, ANY EQUINE SPONSOR OR EQUINE PROFESSIONAL IS NOT LIABLE FOR ANY INJURIES TO, OR DEATH OF, A PARTICIPANT IN ANY EQUINE ACTIVITIES EFFECTIVE UNDER FLORIDA LAW. **BE WARNED THAT RIDING OF HORSES/PONIES IN ANY EQUINE SPORT IS AN INHERENTLY DANGEROUS RISK TO THE RIDER AND/OR PROPERTY (SENATE BILL 1658- SECTION 91.1A). ALL JUNIOR RIDERS MUST WEAR REGULATION HELMETS AND CHIN STRAPS MUST BE SECURELY FASTENED WHILE MOUNTED AND ALL RIDERS MUST WEAR A HELMET WHILE JUMPING.**

Rider/Parent/Guardian Signature: \_\_\_\_\_

(Must be 18 or older to sign)

Trainer Signature: \_\_\_\_\_

Date Membership Effective: \_\_\_\_\_

**\$30.00 per member      \$50.00 family membership**

**\*\*Please review Heritage's rules and regulations on our website.\*\***

**\*\*Coggins must be available upon demand\*\***

11351 NW 23<sup>rd</sup> Street Plantation, Florida 33323 Phone: 954.448.5492 E-mail: HeritageHorseSho@aol.com  
www.HeritageHorseShow.com

Barn: \_\_\_\_\_

Horse Name: \_\_\_\_\_

Owner Name: \_\_\_\_\_

Phone Number #1:

\_\_\_\_\_

Phone Number #2:

\_\_\_\_\_



Fri.					
9:00 pm	Up	Down	Eating	Sleeping	
11:00 pm	Up	Down	Eating	Sleeping	
1:00 am	Up	Down	Eating	Sleeping	
3:00 am	Up	Down	Eating	Sleeping	
Sat.					
9:00 pm	Up	Down	Eating	Sleeping	
11:00 pm	Up	Down	Eating	Sleeping	
1:00 am	Up	Down	Eating	Sleeping	
3:00 am	Up	Down	Eating	Sleeping	

Barn: \_\_\_\_\_

Horse Name: \_\_\_\_\_

Owner Name: \_\_\_\_\_

Phone Number #1:

\_\_\_\_\_

Phone Number #2:

\_\_\_\_\_



Fri.					
9:00 pm	Up	Down	Eating	Sleeping	
11:00 pm	Up	Down	Eating	Sleeping	
1:00 am	Up	Down	Eating	Sleeping	
3:00 am	Up	Down	Eating	Sleeping	
Sat.					
9:00 pm	Up	Down	Eating	Sleeping	
11:00 pm	Up	Down	Eating	Sleeping	
1:00 am	Up	Down	Eating	Sleeping	
3:00 am	Up	Down	Eating	Sleeping	

Barn: \_\_\_\_\_

Horse Name: \_\_\_\_\_

Owner Name: \_\_\_\_\_

Phone Number #1:

\_\_\_\_\_

Phone Number #2:

\_\_\_\_\_



Fri.					
9:00 pm	Up	Down	Eating	Sleeping	
11:00 pm	Up	Down	Eating	Sleeping	
1:00 am	Up	Down	Eating	Sleeping	
3:00 am	Up	Down	Eating	Sleeping	
Sat.					
9:00 pm	Up	Down	Eating	Sleeping	
11:00 pm	Up	Down	Eating	Sleeping	
1:00 am	Up	Down	Eating	Sleeping	
3:00 am	Up	Down	Eating	Sleeping	

Barn: \_\_\_\_\_

Horse Name: \_\_\_\_\_

Owner Name: \_\_\_\_\_

Phone Number #1:

\_\_\_\_\_

Phone Number #2:

\_\_\_\_\_



Fri.					
9:00 pm	Up	Down	Eating	Sleeping	
11:00 pm	Up	Down	Eating	Sleeping	
1:00 am	Up	Down	Eating	Sleeping	
3:00 am	Up	Down	Eating	Sleeping	
Sat.					
9:00 pm	Up	Down	Eating	Sleeping	
11:00 pm	Up	Down	Eating	Sleeping	
1:00 am	Up	Down	Eating	Sleeping	
3:00 am	Up	Down	Eating	Sleeping	



## Team Challenge Entry

Team Name \_\_\_\_\_

RIDER/HORSE	#	CLASS			TOTAL POINTS
1. _____ _____		Class: ____  Points:____	Class ____  Points____	Class____  Points____	
2. _____ _____		Class: ____  Points:____	Class ____  Points____	Class____  Points____	
3. _____ _____		Class: ____  Points:____	Class ____  Points____	Class____  Points____	

Team Total: \_\_\_\_\_

## Trophyland Barn Challenge Entry

**Barn Name** \_\_\_\_\_

**Saturday**      **Show Date:** \_\_\_\_\_

RIDER/HORSE	#	CLASS			TOTAL POINTS
1. _____ _____		Class: ____	Class ____	Class____	
		Points:____	Points____	Points____	
2. _____ _____		Class: ____	Class ____	Class____	
		Points:____	Points____	Points____	
3. _____ _____		Class: ____	Class ____	Class____	
		Points:____	Points____	Points____	

**Team Total:** \_\_\_\_\_

**Sunday**      **Show Date:** \_\_\_\_\_

RIDER/HORSE	#	CLASS			TOTAL POINTS
1. _____ _____		Class: ____	Class ____	Class____	
		Points:____	Points____	Points____	
2. _____ _____		Class: ____	Class ____	Class____	
		Points:____	Points____	Points____	
3. _____ _____		Class: ____	Class ____	Class____	
		Points:____	Points____	Points____	

**Team Total:** \_\_\_\_\_

## Directions to Palm Beach County Jim Brandon Equestrian Center

**From I-95:** Exit Forest Hill Blvd. Go west on Forest Hill Blvd. for approximately 6 miles. After passing Pinehurst Dr., make the next left into Okeehewee Park South.

**From the North on Florida's Turnpike:** Exit #97-Southern Blvd. After toll booth, turn left onto Pike Rd. (South). Make a left onto Southern Blvd. (East) and go to Jog Road. Make a right onto Jog Road (South) to Forest Hill Blvd. Make a right onto Forest Hill Blvd. (West). After passing Pinehurst Dr., make a left into Okeehewee Park South.

**From the South on Florida's Turnpike:** Exit #93-Lake Worth Rd. and go east to Pinehurst Dr. Make a left onto Pinehurst Dr. (North) and go to Forest Hill Blvd. Make a left onto Forest Hill Blvd. (West). Make the next left into Okeehewee Park South.

**From the West on Forest Hill Blvd.:** Cross over Florida's Turnpike and make a right into Okeehewee Park South.

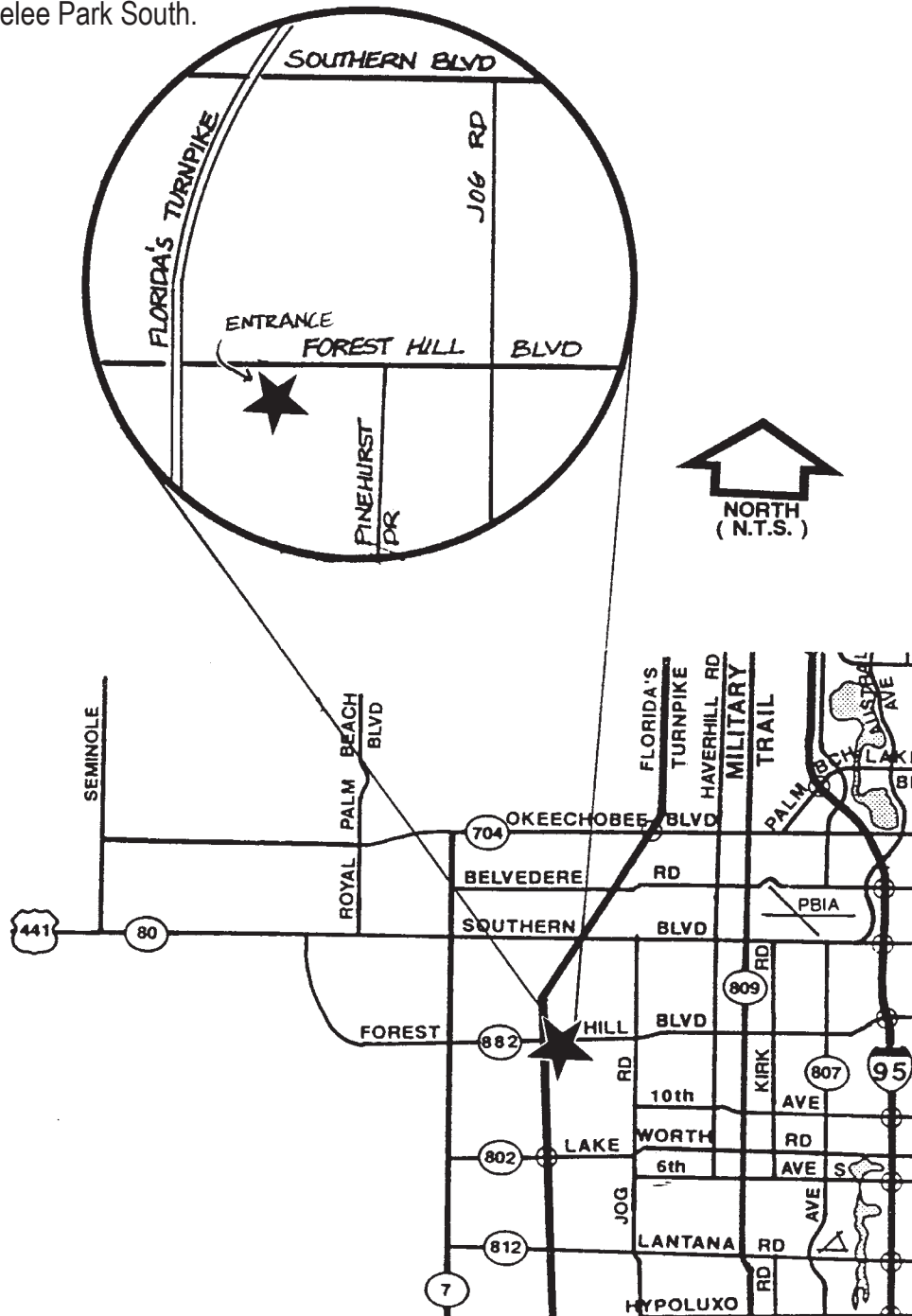

# PALM BEACH COUNTY JIM BRANDON EQUESTRIAN CENTER

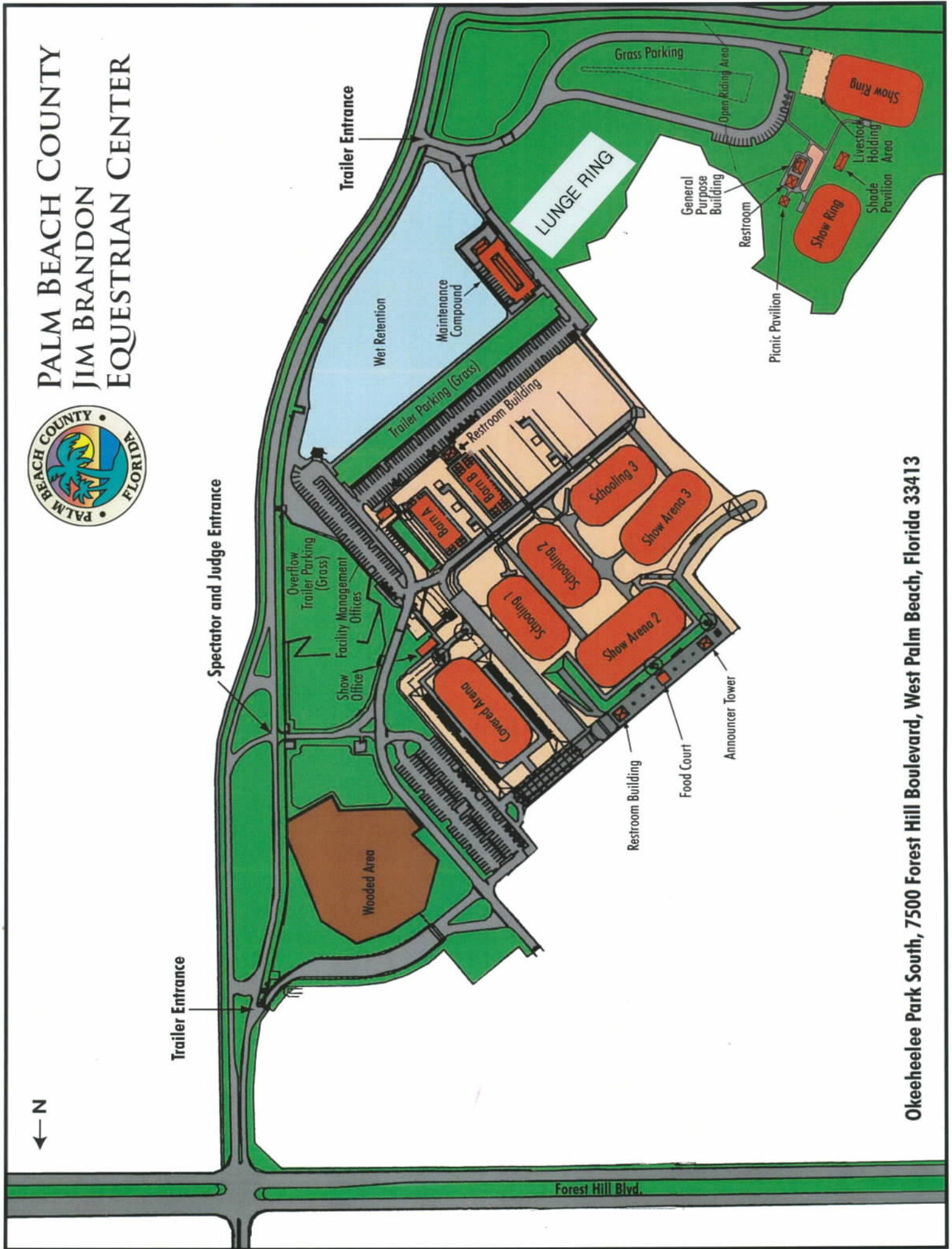

Okeehelée Park South, 7500 Forest Hill Boulevard, West Palm Beach, Florida 33413